

B2789 - 51" Rear mount snowblower

For:

BX and B tractors

FEATURES:

- 51" cutting width 2 stage snowblower
- Chute and gear box kit included
- Replaceable cutting edge
- Optional manual or hydraulic chute rotation
- Optional hydraulic chute deflector and electric selector valve kit or electric chute deflector
- Optional width extensions (increases width by 5")

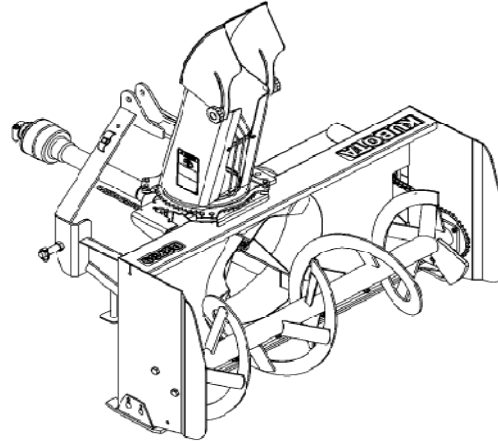

SPECIFICATIONS	
Total width	51"
Total height (without chute)	28 3/8"
Total length	39 1/2"
Cutting width	51"
Cutting height	23 1/2"
Frame thickness	12 Ga.
Side thickness	7 Ga.
Impeller back housing thickness	12 Ga.
Impeller side housing thickness	12 Ga.
Number of phases	2
Primary drive	Driveline 02 series
Auger drive	Chain #50
Driving sprocket	H50A17
Driven sprocket	50A36
Impeller drive	Gear box comer L25 ratio 1.5:1 (4500039)
Driveline	02 series (4700100)
Auger diameter	15"
Auger pitch	14 1/2"
Impeller diameter	20"
Impeller width	6"
Number of blades on impeller	4
Impeller R.P.M.	540 R.P.M.
Auger R.P.M.	170 R.P.M.
Chute position	Right
Chute rotation	Hydraulic or manual.
Adjustable deflector	Manual, hydraulic optional
Adjustable skid shoes	Yes
Cutting edge	Replaceable
Number of shear bolts on auger	1 (on drive shaft)
Number of shear bolts on impeller	1 (on driveline)
Hitch system	Cat. 1 ASAE standard and ASAE quick hitch
Approx. shipping weight	370 Lbs.
Recommended PTO hp	13 to 26 HP